



Optional 50HZ



EAf pumps with guide rail device

Optional



EAf pumps with SUS304 strainer

### ▲ Features

- Non-clogging impeller minimizes abrasives wear and allows large solid passage.
- Dry motor with overload protector, cable with an epoxy resin sealed water-proof cable hood, high grade cast iron pump casing and motor housing, deep groove C3 bearing to extend life time.
- Superior abrasion resistant double mechanical seal made of silicon carbide to ensure best seal effect.
- Guide Rail Device is available for safety purpose.
- Oil seal mounted outside of seal chamber stops solids gathering around seal faces.

### ▲ Applications

- Waste water drainage from all industries.
- Sewage drainage from hotels, restaurants, schools, malls, and public buildings..etc.
- Fishery, animal husbandry, stock farm, piggery, and fecal sewage tank in water treatment plant.
- Drainage of waste water containing fibrous additives from leather factories, dyeing factories and food processing plants.

### ▲ Parts and Materials List

No.	Parts	Std. Material
		EAf Model
1	Cable	VCT
2	Cable hood	PVC
3	Handle	SS400
4	Motor cover	FC200
5	Seal housing	FC200
6	Bracket	FC200
7	Oil chamber	FC200
8	Pump casing	FC200
9	Impeller	FC200
10	Nut	SUS304
11	Mech. seal	SIC/SIC
12	Oil seal	NBR
13	Bearing	(NTN or NSK brand)
14	Overload protector	(T.I.brand)
15	Shaft	SUS410
16	Motor housing	FC200
17	Lubricant oil	(Turbine Oil ISO VG46)

● Mech.seal (sic/sic)material is optional upon request.

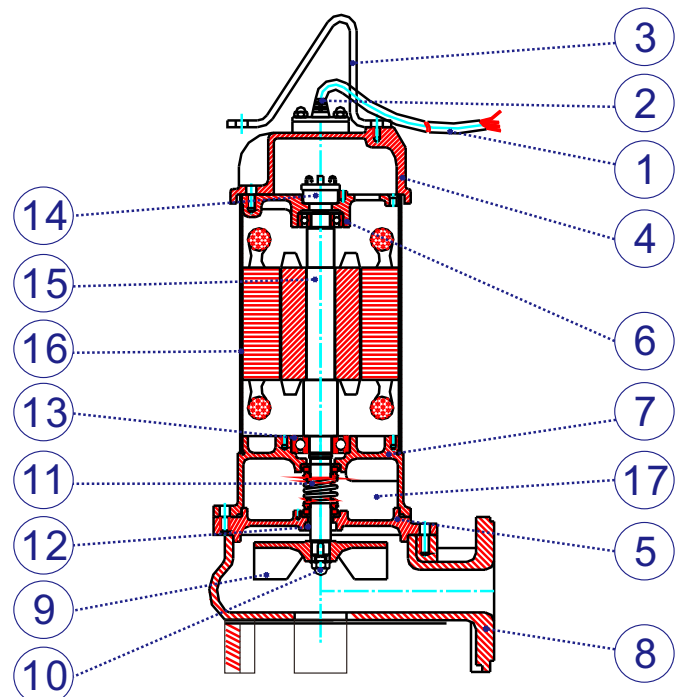

### Model Code

**EAF-20/4**

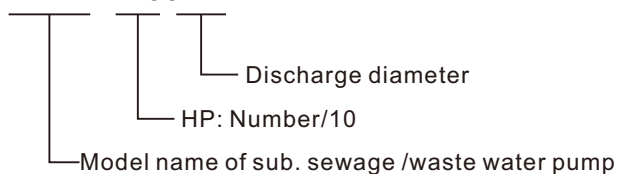

**Semi-open (Vortex impeller)**

It can allow long fibrous materials and other solid waste to pass through. No clogging impeller.



**Auto float switch**

Single phase sub. pump equipped with auto float switch.(2hp)

**50HZ**

### Operating Conditions

- Water temperature: 0~40°C.
- Ambient temperature: 0~40°C.
- Solid passage: 35~50MM.
- Operating water depth: Max.10M.
- No 24hrs continuously running.
- No use in (100%)sea water.

### Motor Spec.

- 2P or 4P dry type motor.
- Insulation: F class.
- Protection: IP68.
- Frequency: 50HZ.
- Voltage: 3ø220~440V(all models).

### Performance Curves

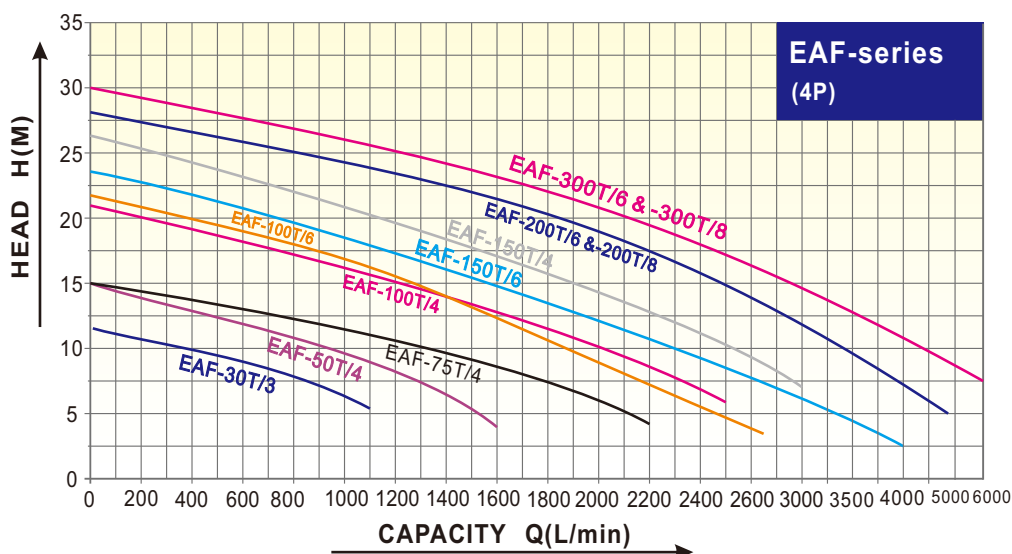

### Specification & Dimensions

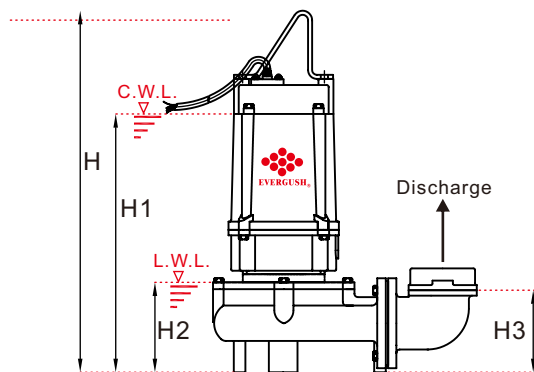

C.W.L.: Continuously Running Water Level.  
L.W.L.: Lowest Running Water Level.

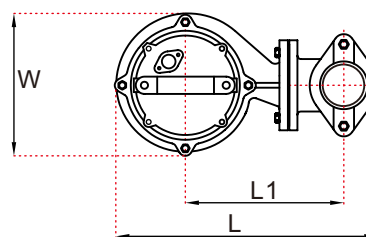

**NOTE:** Forbid running submersible pumps continuously under L.W.L.

Model	Power		Disch.	Pole	Rated		Max.		Dimensions (mm)						Cable	Net Weight	Solid Passage	
	KW	HP			Head	Capacity	Head	Cap.	L	L1	W	H	H1	H2				H3
EAF-30T/3	2.2	3	3"	4	9~10	500~400	11	1050	560	233	310	620	379	132	121	10	80	40
EAF-50T/4	3.7	5	4"	4	9~10	1000~900	14	1500	560	233	310	680	409	132	121	10	86	40
EAF-75T/4	5.5	7.5	4"	4	11~12	1100~1000	14	2100	600	256	360	710	465	182	200	10	108	40
EAF-100T/4	7.5	10	4"	4	17~18	1000~900	22	2400	730	256	430	820	505	182	200	10	154	40
EAF-100T/6	7.5	10	6"	4	10~11	2000~1900	24	2800	780	360	480	820	700	337	350	10	184	45
EAF-150T/4	11	15	4"	4	21~22	1000~900	26	3000	730	435	430	900	812	391	406	10	200	45
EAF-150T/6	11	15	6"	4	17~18	2000~1900	22	4000	940	435	480	950	838	403	412	10	250	50
EAF-200T/6	15	20	6"	4	20~19	2000~1900	28	4900	940	435	480	950	846	407	423	10	250	55
EAF-200T/8	15	20	8"	4	13~12	4000~3900	28	4900	950	435	480	950	846	407	423	10	270	60
EAF-300T/6	22	30	6"	4	25~22	2000~2500	30	6300	950	435	480	990	846	407	423	10	290	55
EAF-300T/8	22	30	8"	4	21~18	4000~3500	30	6300	950	435	480	990	846	407	423	10	300	60

Remarks: ●(A): Equipped with automatic float switch. ●(T): Three phase motor. ●10M cable are available for all models per special request.



### Product Features:

50HZ

- Through simple and convenient installation, we can connect the pump onto guide rail device. Whenever the pump needs maintenance, it can be easily pulled out through guide bar to dismantle, repair or examine the pump. For safety purpose, The workers no longer need to go down the septic tank to do maintenance. It will greatly reduce down time.

### Applications:

- Animal husbandry and dairying septic tank waste water drainage; sewers, apartments, buildings and basements sewage treatment equipment drainage; Dye house, fur and leather industry and steel industry waste water drainage; other waste water treatments drainage.

### Installation Diagram:

#### Step 1

Guide rail device should connect to discharge pipeline. It should be firmly fixed to the bottom. After that, you should use mounting bracket connects to the guide bar.

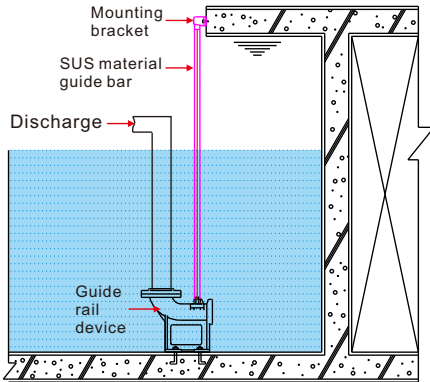

#### Step 2

The hook should connect to the pump. After that, you should use the chain to slowly slide it down through guide bar.

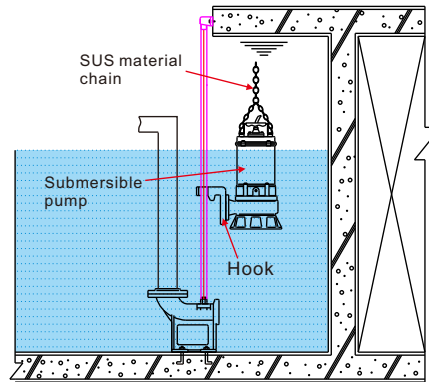

#### Step 3

The pump will slide down through guide bar until it connects to guide rail device tightly.

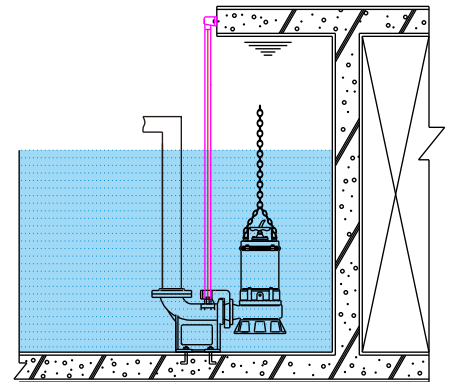

### Dimensions:

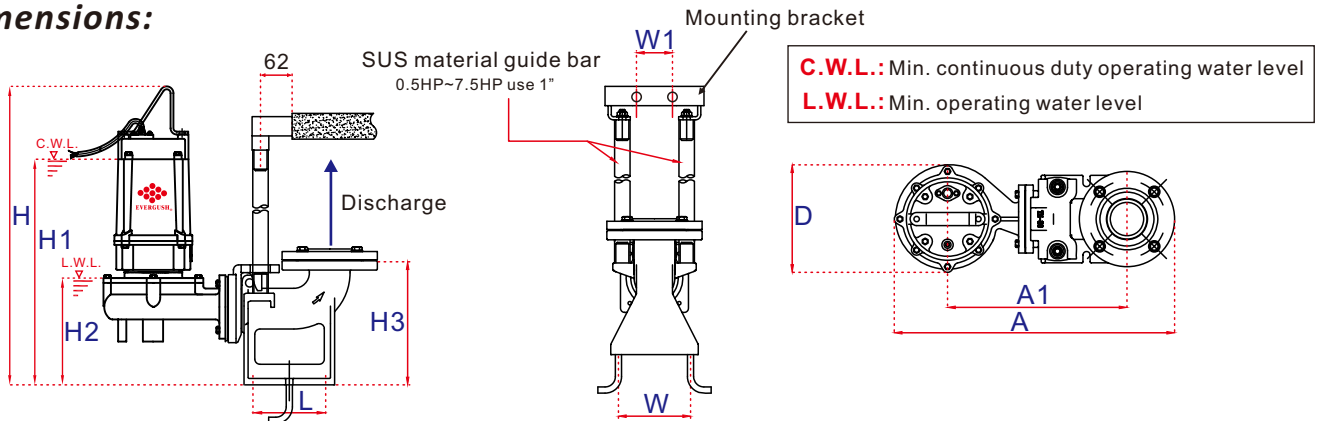

Model	Disch.		Power		Dimensions(mm)								TOS Weight KG
	Inch	HP	A	A1	D	H	H1	H2	H3	L	W	W1	
TOS-EAF-30T/3	3"	3	547	352	210	607	455	208	241	—	140	70	16
TOS-EAF-50T/4	4"	5	547	352	210	637	485	208	241	---	140	70	16
TOS-EAF-100T/4/6	4"~6"	10	675	473	227	733	573	290	310	160	150	70	24
TOS-EAF-150T/4/6	4"~6"	15	675	473	227	773	613	290	310	160	150	70	24
TOS-EAF-200T/6/8	6"~8"	20	996	794	480	928	765	445	465	—	200	70	40
TOS-EAF-300T/6/8	6"~8"	30	996	794	480	950	765	445	465	—	200	70	50